

# **Installation manual**

## **CheckWatt CM10 and Solis inverter**

### **S6-EH3P(29.9-50)K-H**

#### **Updated 2024-11-26**

Installation of CheckWatt CM10 and the Solis inverters is performed according to their manuals. This manual describes how communication between the CheckWatt CM10 and Solis inverter is established.

Communication between CM10 and inverter is carried over modbus RTU (RS-485) via ethernet cable CAT6 FTP.

Max inverters per CM10: 1



## Installation: Internet connection and communication

**Connect** the WAN (Ethernet cable) between the property's router\* and **LAN 1 (eth0)** on the CM10 for internet connection to the CM10.

*\* or other network equipment such as PLC-modem, wifi-repeater or network switch.*

*NOTE! LAN 1 and LAN 2 must not be mixed up as they have different functions.*

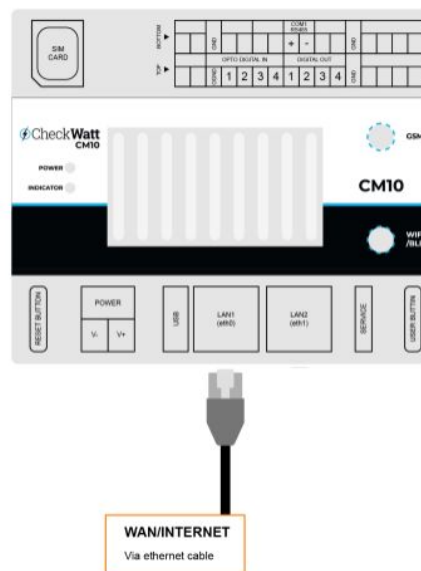

The **ethernet** cable needs to be **stripped** on **one side** where pin 4 (Blue) and pin 5 (blue/white) represent 485B and 485A, respectively.

Connect the **blue** cable to terminal **#8** on the rear row marked **COM -**.

Connect the **blue/white** cable to terminal **#9** on the rear row marked **COM +**.

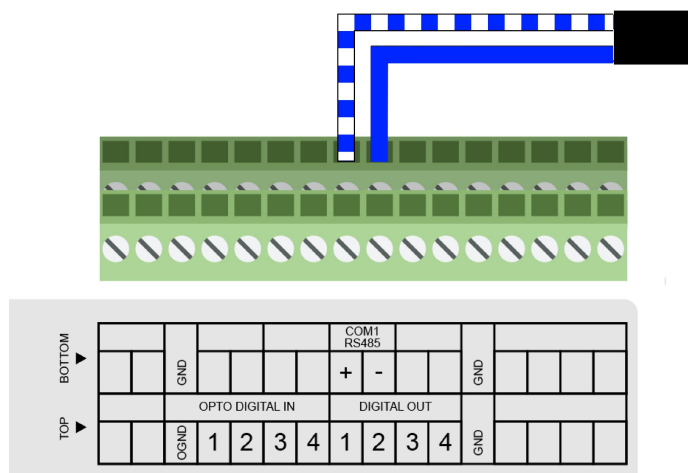

## Installation: Internet connection and communication

Connect the Ethernet cable into the Solis inverter through the input marked **EMS**.

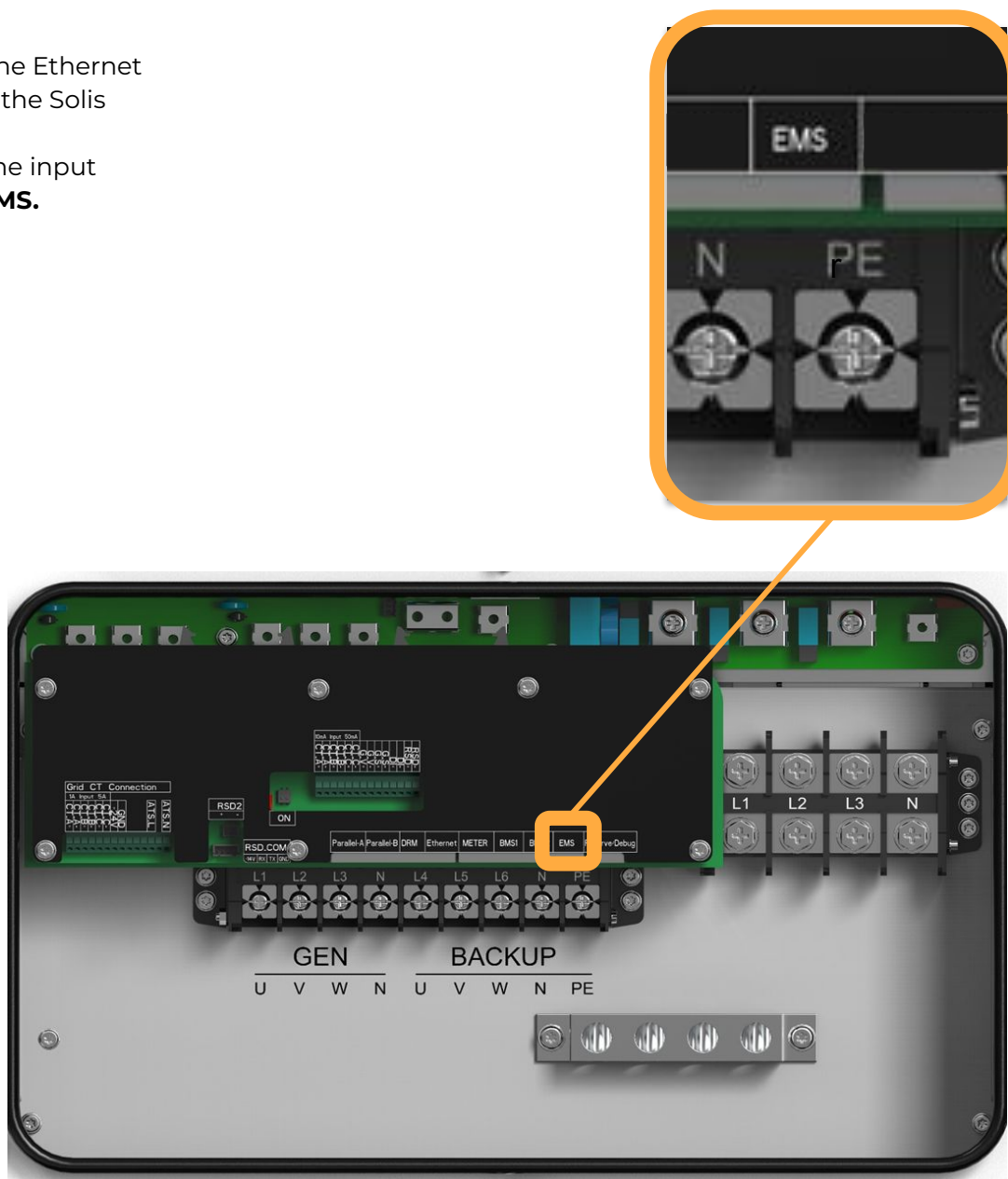

## Settings

1 a) Allow Grid  
Charging, set to **Enable**.

Cancel      Allow Grid Charging      Save

Current Value: Disable

Enable



Disable

## Firmware update inverter

When the installation is complete, a support ticket should be submitted to the [Solis Service Center](#) to update the inverter to the correct firmware. You can do this by logging in to the Solis Service Center and then clicking on “Submit a Ticket.” If you don't have an account, you will need to create one.

In the description, write:

Firmware update for CheckWatt VPP services